



PANTHER INDUSTRIES

8990 Barrons Blvd.
Highlands Ranch, CO 80129
Office: 303.703.9876
Toll free: 800.530.6018
Fax: 720.283.9462

**FIND A
SOLUTION**

PANTHER INDUSTRIES

The little company that could

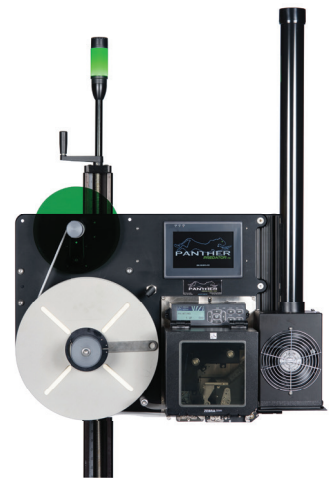

Panther Industries, based in Highlands Ranch, Colorado, is a manufacturer of automated labeling equipment. Panther's founder James Thompson became acquainted with print-and-apply labeling at a meatpacking plant in which he once worked, according to company Vice President Christian Dow. While there, he improved upon a simple version of the plant's labeling equipment by replacing a relay-logic system with a Programmable Logic Controller, a digital computer that enhanced and sped up the electromechanical labeling process.

"This was one of the first programmable logic controllers that was implemented into a labeler in those days," says Dow. "Later on, Jim became an engineering manager for a company called Stadia Label, the manufacturer of the equipment that he put the PLC onto. They had recognized what he had done and were floored by his innovation. That company moved to New England, but Jim remained in Colorado as a contract employee, working remotely. And after a few years, he decided it was time that he started his own company."

Panther's first product was the Panther 2000, a fast, reliable, configurable, and rugged print-and-apply labeling system with a display that offered self-diagnostics, while providing informative data and accepting user input. The first machines were sold to the Colgate-Palmolive Company, and Dow relates that the Panther 2000 is still in production, today, being made by the company's 22 employees in its 36,000 square foot manufacturing facility in Highlands Ranch, Colorado.

Panther maintains a wide network of industry partners, integrators, and resellers, who help widen the company's reach.

"We do a lot of business in the United States, and Canada is our second largest market," says Dow. "But we also do international. This year, we have systems being installed in Mexico, Brazil, South Africa, Australia, and India."

Panther provides both print-and-apply labeling systems as well as pre-printed label applicator

Panther provides both print-and-apply labeling systems as well as pre-printed label applicator systems. Over the years, the company has also created many special solutions for clients that have since become standard in the industry.

It's been Panther's continual innovations in engineered labeling solutions that have differentiated it from its competitors.

The **wardcraft**
family

PANTHER AUTO APPLICATOR



Benefits:

- Clean Labeling on outside of box
- Shipping label has packing list or return label underneath
- NO PLASTIC POUCH OR INSERTING PACK SLIP
- Fast, clean, no hands AUTO application saves time and money

Other DISTRIBUTION PRODUCTS



**DUPLEX THERMAL
& LASER**



**INTEGRATED
FORM/LABEL**



**FOLD
UNDER**



**PRINTING UNDER
SILICONE**

Call Curt Today!

800.821.4021 ext 5116

Call today to learn more or scan this barcode to request samples.





CONTACT A CUSTOMER SERVICE REPRESENTATIVE TODAY!

800.821.4021

Ward/Kraft, Inc. is a nationally known leader in the design and production of Labels, Plastics, Commercial Print, Mailers, and Business documents. The company serves clients in the commercial, distribution, educational, financial, government, healthcare, hospitality, insurance, manufacturing, and direct mail sectors.

For Panther Industries, a long-time client with high volume and fast-moving packaging equipment, Ward/Kraft provides its two-label AUTOPACKLIST label. This label is designed to work in the Panther auto-applicator capable of printing a shipping label on top of a packing list or on a return label that applies directly underneath the shipping label.

The auto-applicator eliminates the need for a plastic pouch or an inserted packing slip. With everything being printed simultaneously, errors are eliminated and the whole process is streamlined where everything appears neat and clean on the outside of the package.

Ward/Kraft is available to work directly with your company, too, to find the best solutions for your packaging and labeling needs. We have a wide variety of shipping solutions with thermal and laser print products, integrated form labels, fold-under labels, and we can even print under silicone! Please contact us for more information.

www.wardkraft.com

systems. Over the years, the company has also created many special solutions for clients that have since become standard in the industry. Examples of a special system might be one that puts flag labels on thin medical device cables, and another that is tailored to wrap and label pharmaceutical bottles moving swiftly on a conveyor belt. Indeed, it's been Panther's continual innovations in engineered labeling solutions that have differentiated it from its competitors.

More recently, the company's technological expertise has resulted in some rapid expansion. Dow says that over the last couple of years, Panther Industries has moved resolutely into the logistics of the e-commerce sector and is now a supplier to some of the biggest online retailers, including many Fortune 100 companies.

"Our systems are really tailored to do the e-commerce business, labeling a lot of different-sized and different-shaped product – on the fly – in a way that doesn't need any human intervention or interaction with the product as it goes by," Dow explains.

Another aspect of Panther Industries that separates it from the competition is the capability the company to communicate with its own machinery and for the machines, themselves, to interact with one another up and down the supply chain.

"We've always allowed, and had the ability to give, all kinds of information based on every single status that happens to our machines," says Dow. "Since about 2007-08, with the launch of the Panther P8, we've had all this ability over the internet, and Ethernet/IP, and Modbus/TCP, and TCP/IP, and other networks that we communicate over, to give our customers all this information. Meanwhile, we're getting to a point where we're going to be offering the next generation of communication, increasing our speeds, and creating even more functionality in our system to apply more labels in less time, and allowing a single line to do more throughput."

In addition, because Panther systems have error reporting and recommended solutions either on a

system display, or right within the system, itself, Dow says that “most operators can solve just about any problem that comes up.” However, if they can’t, the company offers a 24/7 phone support.

“This is something where we’ve always stood out differently from our competition; we were the first ones to go down this path,” he continues. “We give the operator the ability to be the first line of defense and then we have 24/7 support at no cost to the customer for the life of the machine. So, even the systems that we have out there that are 16 years old, we still offer 24/7 support and we still support the components on those systems.”

Because of Panther’s combination of innovative engineering, precise manufacturing, and excellent customer support, Dow says the company has prospered largely through word-of-mouth, and with the aid of a few strong partners and integrators that have carried its banner and helped to get the company to where it is today. In addition, Panther has always participated in the industry’s largest trade shows: the PACK EXPO put on by the Association for Packaging and Processing Technologies, and the Material Handling Industry of America’s MODEX and PRO-MAT events. But last year, the company finally added its own marketing manager, Spencer Winegarden, who is now responsible for its digital strategy, including the oversight of a much more optimized website and an enhanced social media presence.

Dow admits that Panther’s robust growth has created some challenges for this pioneering company with an





“ This is something where we've always stood out differently from our competition; we were the first ones to go down this path. We give the operator the ability to be the first line of defense and then we have 24/7 support at no cost to the customer for the life of the machine.

Company Vice President Christian Dow

BRIGHT IDEAS

Any Space

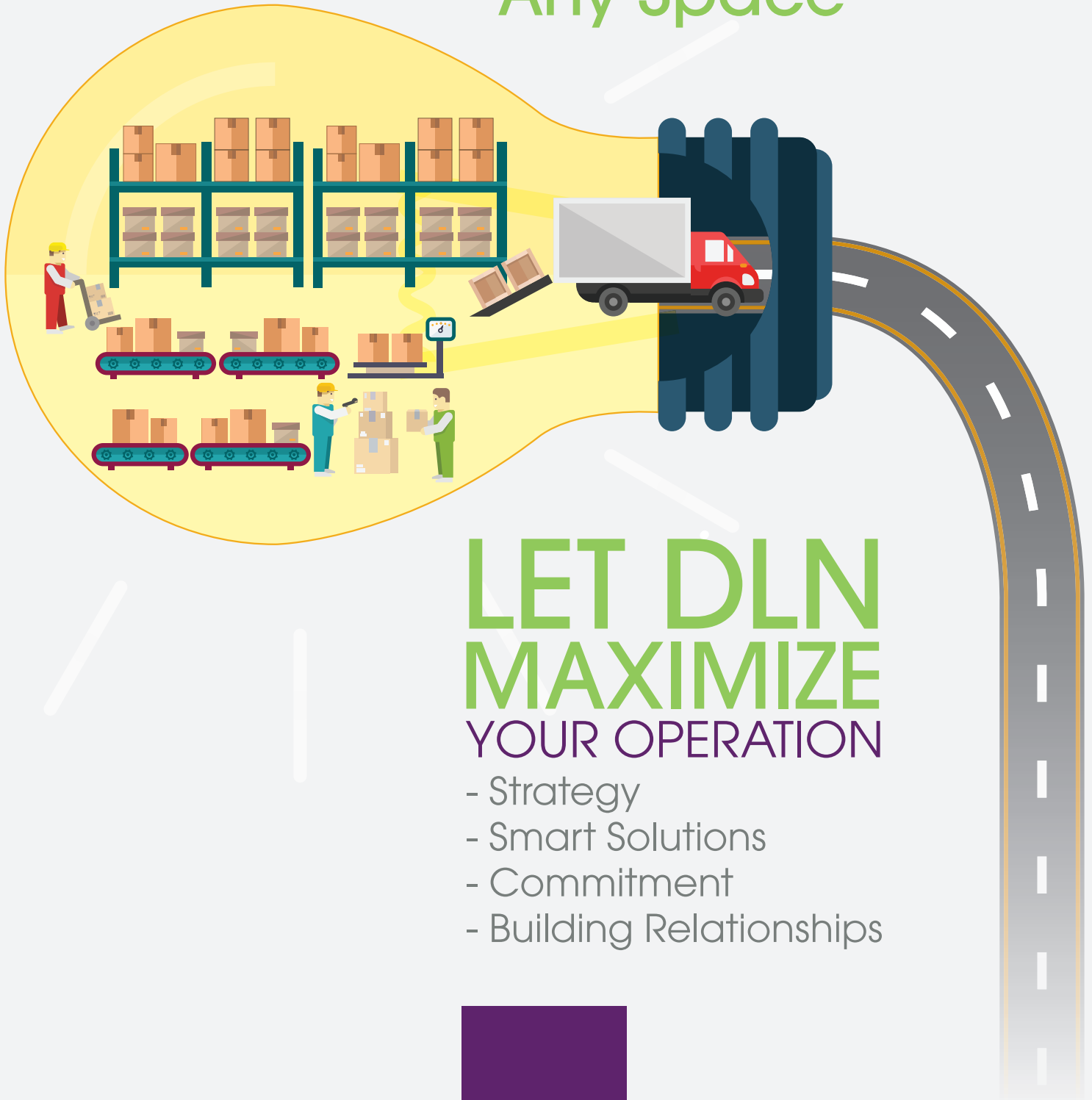

LET DLN MAXIMIZE YOUR OPERATION

- Strategy
- Smart Solutions
- Commitment
- Building Relationships



D.L. NEU & ASSOCIATES
INTEGRATED SYSTEMS



D.L. NEU & ASSOCIATES INTEGRATED SYSTEMS

D.L. Neu & Associates Inc. is a provider of Distribution Center Automation based near Grand Rapids, Michigan. The company provides its services for all sized projects through, and including, large turnkey systems, specializing in concept layout and detail system engineering.

D.L. Neu & Associates Inc. provides comprehensive integrated solutions utilizing equipment and technologies from several manufactures tailored to each client's exact needs across several industries. This allows them to implement the most efficient and effective solutions that fit the application based on the latest technology.

With an average of over 20 years' experience, each expert at D.L. Neu has a unique perspective that allows the team to provide the smartest solutions. As engineers, the D.L. Neu team not only provides smart solutions but also gets their hands dirty, taking responsibility for installation, support and service. D.L. Neu's unique size combined with their experience allows for flexible and responsive engagement with each client.

www.dlneu.com | 616.583.0638

5805 Weller Court, Suite A, Wyoming, MI 49059

AT A GLANCE

- Panther Industries is a third party logistics provider that offers its clients transportation services and logistics solutions
- Based in Highlands Ranch, Colorado
- www.print-n-apply.com

increasing portfolio.

"We're growing from a very small company only a few years ago to something that's getting into a medium size," he says. "We've needed to add more processes in place to support that growth. When you're a small company, you can be very innovative, customer-centric, reactive, and provide a quality product with excellent service. Our goal is to continue to do that – but still be as agile."

And Panther Industries is nothing if not innovative.

"We're spending a lot of time and energy and investment in our R & D," says Dow.

The company is getting ready to launch a new system, the Predator P9, which is a successor to the P8, one of the company's current flagship models.

"It's innovation that we're most proud of," Dow states emphatically. "Of being a leader in the industry. Here's a little company out of Colorado. We shouldn't be as good as we are and have as much of a presence as we do. But based on the people we have and the way we do things, we've made an impact. And this year has been a year of fantastic growth for us."

And that's just the way it should be when a company's innovative engineering, its precision manufacturing, its network of industry partners, and its excellent customer service come together to meet its clients' labeling needs; proving that Panther Industries is truly the little company that could.

The NuminaGroup

Increase Distribution Productivity by 50% or More

Voice-Driven Automated Pick, Pack, and Ship Order Fulfillment Automation

- Reduce Labor – 35% to 70% & Gain 99.99% Accuracy
- Automate Pack & Ship – Pack Sheet and Ship Label using Panther Print & Apply Label Applications
- Real-Time Distribution System, RDS™ - WES/ WCS Integrates to Existing ERP Systems

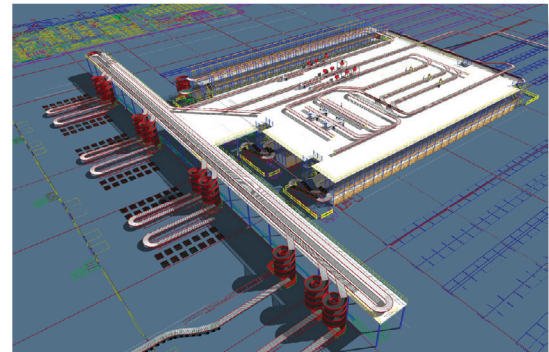

Proven Results: Faster Delivery Window, Superior Accuracy, and Higher Profitability!

Call 630-343-2622 to get the latest white papers and customer success stories.



Software is the Key Component for increased distribution profitability. The RDS™ Order Fulfillment Automation Module provides unsurpassed performance in Pick, Pack, Ship, Conveyor, and Order Fulfillment Sorting Control Applications.

**Lean Design – Perfect Order Practices
Proud to Partner with Panther Industries**



The NuminaGroup

The Order Fulfillment Experts.

10331 Werch Drive, Woodridge, IL 60517 630-343-2600
www.numinagroup.com

The Numina Group is a leading supplier of **Warehouse Execution and Control Systems, WES-WCS and Material Handling Integration Services** with over 30 years of define, design, and implementation of software and automation that improves distribution profitability.

Our Real-time-Distribution System, RDS™ includes a voice directed order fulfillment module that manages picking processes to reduce touches, lower labor costs, and increase throughput in the **Pick, Pack, and Ship Process**. RDS™ Voice is speaker independent - it requires zero operator training time and it increases picking accuracy to 99.99% and productivity by 30+%.

Pack and Ship Automation includes a full family of packing technologies, including in-line pack sheet print and insertion and Panther print and apply labeling integrated with intelligent conveyor and sorting solutions. Numina Group's labeling solutions are based on **Panther Industries high performance label applicators**.

Regardless if your needs are a single scan-weigh print and apply manifesting system or a turn-key high volume distribution operation, you can rely on the expertise of The Numina Group to deliver a solution that will reduce labor, eliminate errors, and increase productivity across your entire order fulfillment operation.

PREFERRED VENDORS

Ward/Kraft

Ward/Kraft, Inc. is a nationally known leader in the design and production of labels, plastics, commercial print, mailers, and business documents. The company serves clients in the commercial, distribution, educational, financial, government, healthcare, hospitality, insurance, manufacturing, and direct mail sectors, providing a wide variety of shipping solutions, including thermal and laser print products, integrated form labels, and fold-under labels. www.wardkraft.com

Numina Group

Founded in 1986, the Numina Group provides a full range of services, including consulting/design, voice directed picking, pack & ship order fulfillment automation, Warehouse Control Systems, conveyor systems, and material handling and control for turnkey automated distribution operations. Numina Group's Real-time Distribution System, RDS, is a Tier 1 Warehouse Control System, with an advanced order fulfillment automation module that delivers pick, pack, and ship process improvements for manufacturing and distribution operations worldwide. www.numinagroup.com

D.L. Neu & Associates

D.L. Neu & Associates Inc. is a material handling equipment supplier based in Wyoming, Michigan. The company provides its services from the smallest material handling projects through, and including, whole turnkey systems, specializing in concept layout and detail product/system engineering. It is staffed with engineers experienced in a number of different industries, including grocery distribution, pharmaceutical, parcel, retail, manufacturing, and e-commerce. www.dlneu.com

StreamTech Engineering, LLC

www.streamtecheng.com



8990 Barrons Blvd.
Highlands Ranch, CO 80129
Office: 303.703.9876
Toll free: 800.530.6018
Fax: 720.283.9462

FIND A SOLUTION

www.print-n-apply.com

Warehouse Control Software | PLC Controls | Print and Apply Dimensioning
Sortation | In-Motion Weighing Cross Docking | Warehouse Control Software
Picking Systems | Compliance Labeling | Multi-Carrier Shipping



AUTOMATION FOR E-COMMERCE

1249 N. Warson Road St. Louis, MO 63132 | Ph: (800) 797-2130 | Fax: (800) 797-0180
Email: info@streamtecheng.com | www.streamtecheng.com